

SOMERSET STREET

PEMBERTON SQUARE

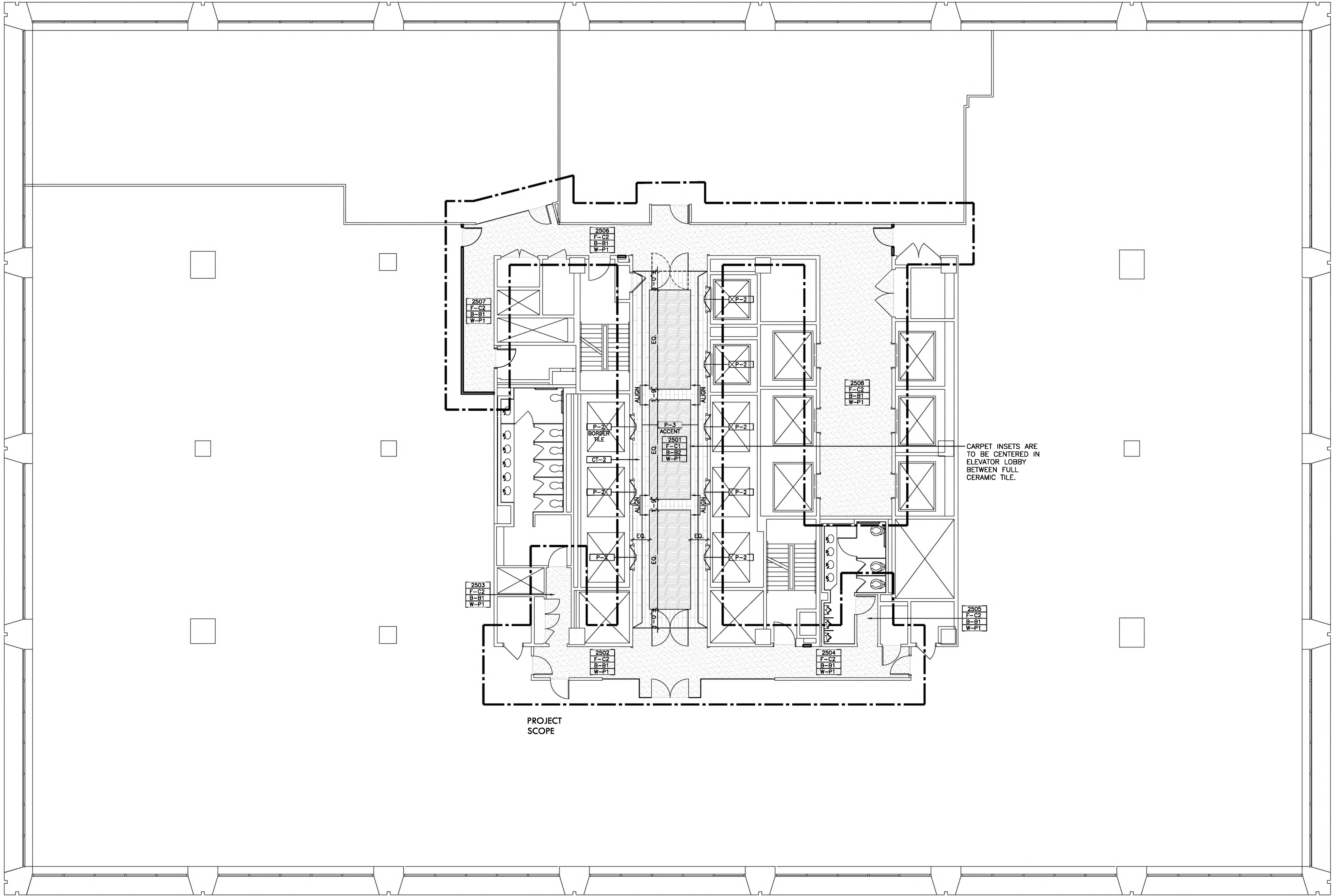

BEACON STREET

TREMONT STREET

FINISH LEGEND:

1111	ROOM NO.
F-C1	FLOOR MAT'L
B-B1	BASE MAT'L
W-P1	WALL FINISH

FLOORING FINISHES

C1	CARPET TILE	COMPANY: STYLE/PATTERN: COLOR: SIZE: REMARKS:	BENTLEY (INSET) RITUAL #88R26 FOLKWAYS #800223 24"x24" TILE SIZE INSET CARPET AT ELEVATOR LOBBY INSTALLATION METHOD (MONOLITHIC)
C2	CARPET TILE	COMPANY: STYLE/PATTERN: COLOR: SIZE: REMARKS:	BENTLEY (CORRIDORS) HIMITSU #4HW20 SECRET #403745 24"x24" TILE SIZE GENERAL CARPET AT COMMON CORRIDORS INSTALLATION METHOD (MONOLITHIC)
CT2	CERAMIC TILE (BORDER)	COMPANY: STYLE/PATTERN: COLOR: SIZE: REMARKS:	TILE BAR KENRIDGE BLACK 8" x 48" TILE SIZE (MATE PORCELAIN TILE) BORDER FLOOR TILE AT ELEVATOR LOBBY STAGGERED PLANK INSTALLATION (GROUT COLOR: LATICRETE #45 RAVEN)

WALL FINISHES

P1	PAINT	COMPANY: COLOR: FINISH: REMARKS:	BENJAMIN MOORE OC-45 (CHANTILLY LACE) EGG-SHELL GENERAL PAINT COLOR THROUGHOUT, U.O.N.
P2	PAINT	COMPANY: COLOR: FINISH: REMARKS:	WOLF GORDON (SCUFFMASTER) SOLID METAL/HARR #5M8008 METALLIC PAINT ELEVATOR DOORS AND FRAMES
P3	PAINT (ACCENT)	COMPANY: COLOR: FINISH: REMARKS:	BENJAMIN MOORE BREWSTER GRAY #HC-162 EGG-SHELL ACCENT PAINT COLOR AT ELEVATOR LOBBY SEE PLAN AND ELEVATIONS

BASE FINISHES

B1	RUBBER BASE	COMPANY: COLOR: REMARKS:	JOHNSONITE BURNT UMBER #63 COMMON CORRIDORS, U.O.N.
B2	WOOD BASE	COMPANY: COLOR: REMARKS:	PAINTED WOOD BASE T80 (SEMI-GLOSS FINISH) EXISTING WOOD BASE AT ELEVATOR LOBBY TO REMAIN AND BE SANDED AND PAINTED

FINISH NOTES:

1. WALL SURFACES BEING PREPARED FOR PAINT SHALL HAVE PAINT APPLIED IN ACCORDANCE WITH MANUFACTURER'S SPECIFICATIONS. PROVIDE A MINIMUM OF (2) FINISH COATS OVER PRIME AS REQUIRED.
2. PAINT ALL DRYWALL CEILINGS AND BOTTOMS OF SOFFITS WITH (2) COATS OF FLAT PAINT.
3. IF REQUIRED, CONTRACTOR TO PROVIDE ALL TEST DATA FOR MATERIALS SPECIFIED TO THE CITY BUILDING DEPARTMENT.
4. WHERE CARPETING OCCURS IN DOORWAYS, INSTALLER TO LOCATE SEAM UNDER THE CENTER OF THE DOOR (ALIGNMENT OF PATTERN IS CRITICAL).
5. CLOSETS ARE TO RECEIVE SAME FINISHES AS SPECIFIED FOR THE ROOM ONTO WHICH THEY OPEN, U.O.N.
6. PROVIDE RUBBER REDUCER STRIPS AT FLOOR MATERIAL JUNCTIONS, COLOR TO BE APPROVED BY THE ARCHITECT. PROVIDE METAL SCHLUTER TRANSITION BETWEEN TILE BORDER AND CARPET AT ELEVATOR LOBBY TO MATCH BUILDING STANDARD.
7. THE G.C. AND THE CARPET SUB-CONTRACTOR SHALL SUBMIT PRIOR TO PURCHASE AND ORDER OF CARPET GOODS A SEAMING DIAGRAM FOR REVIEW AND APPROVAL. ALL ABUTTING PATTERNED REPEAT CARPET SHALL RUN IN SAME DIRECTION.
8. ANY CARPET INSTALLED PRIOR TO OTHER TRADES BEING COMPLETE SHALL PROVIDE ADEQUATE PROTECTION FOR INSTALLED GOODS. THE SUB SHALL HAVE THE EDGES TRIMMED AND SEALED ACCORDING TO THE MANUFACTURERS SPECIFICATIONS. ANY EDGES NOT SEALED THAT RAVEL WILL BE REPAIRED/REPLACED AT THE SUB-CONTRACTORS EXPENSE.
9. G.C. TO SUBMIT SAMPLES OF ALL FINISHES TO ARCHITECT FOR APPROVAL.
10. G.C. SHALL COORDINATE WITH FLOORING SUB ALL REQUIRED FLOOR PREP FOR ALL MATERIALS AND INCLUDE IN PROJECT COST.
11. G.C. SHALL INCLUDE PAINTING FREIGHT LOBBY ELEVATOR DOORS AND FRAMES. INCLUDE PAINTING OF CORE DOORS AND FRAMES IN ELEVATOR LOBBY. SEE NOTES REGARDING PRICING FOR ELEVATORS IN ELEVATOR LOBBY AND REVIEW AS NEEDED PRIOR TO PRICING. SEE NOTES REGARDING ANY CORE DOORS AND FRAMES IN CORRIDORS AND KEEPING EXISTING METALLIC GREY PAINT (REVIEW IF ANY TOUCH UP IS NEEDED PRIOR TO PRICING).

PROJECT:  
**MULTI-TENANT LOBBY / CORRIDOR**  
ONE BEACON STREET  
FLOOR 25  
BOSTON, MA

REVISIONS:	REV. #	DATE:			

TITLE: <b>FINISH PLAN</b>	PROJECT #2023.383	CHK: LSP
	SCALE: 1/8"=1'-0"	DRAWN: JP
	DATE: 4/23/24	

DRAWING NO:  
**A-5**